



Copyright DDI Signs, Inc. 2016

DASHER AD DECAL INSTALLATION INSTRUCTIONS

YOU WILL NEED TWO PEOPLE TO PROPERLY INSTALL. MASKING TAPE, SQUEEGEE, SCISSORS AND/OR EXACTO KNIFE.

REMOVE ALL SHAVINGS AND LOOSE BOARD MATERIAL USING FLAT RAZOR KNIFE, THIS ALLOWS FOR SMOOTHER INSTALLATION. ONCE BOARD SURFACE IS SMOOTH AS POSSIBLE CLEAN SURFACE WELL USING DENATURED ALCOHOL REMOVING DIRT AND OILS - OTHER CLEANERS COULD LEAVE A FILM WHICH CAN WEAKEN DASHER AD ADHESIVE.



1 ALIGN THE DECAL ON THE BOARD WHERE YOU WANT TO INSTALL. TAPE THE CORNERS TO HOLD IN PLACE.



2 TAPE A DOUBLE HINGE IN THE MIDDLE OF THE DECAL.

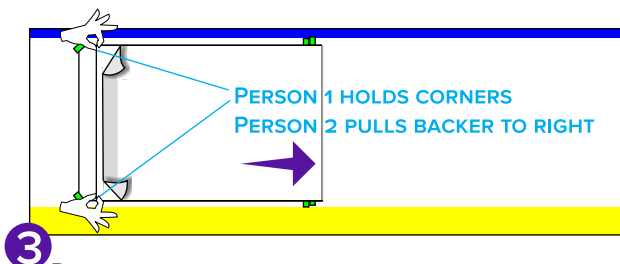

3 REMOVE TAPE FROM RIGHT SIDE AND FOLD BACK TO LEFT. HAVE PERSON 1 HOLD THE CORNERS AND PERSON 2 CAREFULLY PEEL THE PAPER BACKER AWAY FROM DECAL BACK TO THE MIDDLE.

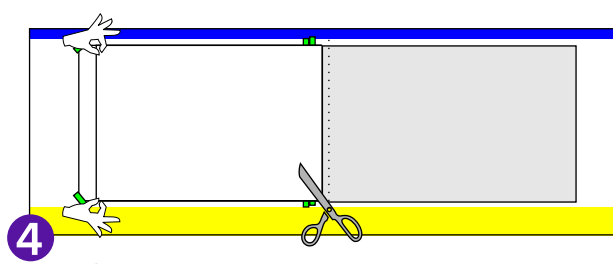

4 CUT THE BACKER AWAY. PERSON 1 HOLDING THE DECAL CAREFULLY MOVE TO THE RIGHT HOLDING THE DECAL AWAY FROM THE DASHER BOARD.



5 PERSON 2 NEEDS A SQUEEGEE AND STARTING IN THE MIDDLE WHERE THE TAPE IS MOVING UP AND DOWN PRESS THE DECAL ON TO THE BOARD REMOVING AIR BUBBLES.



6 REMOVE THE CENTER TAPE HINGE AND CORNER TAPE. REPEAT PROCESS FROM STEP 3 FOR THE LEFT SIDE OF DECAL.

PROPER PREPARATION OF DASHER BOARD SURFACE AND FOLLOWING THIS INSTALL PROCESS WILL RESULT IN PROPER ADHESION TO BOARDS.



© COPYRIGHT DDI SIGNS, INC. 2016